



NOTES  
 -ALL STORMWATER PIPES ARE RCP '2' U.N.O.

**Works As Constructed**

It is certified that the locations, Levels and dimensions of the infrastructure shown herein are a true representation of the constructed works and that the As-Constructed survey was performed to the prescribed accuracy standards.

Authorised Delegate: *C. Walters*  
 Date: 04/12/2019

LandPartners Pty Ltd (ACN 118 146 008) Surveyor No. S4118

**Works As Constructed**

It is certified that works herein have been constructed to Local Government standards, relevant approved specifications and the operational works approval. The As-Constructed Drawings for these works constitutes a true and correct record of the works constructed and complies with the design intent.

Signature: *[Signature]* RPEQ No. 1988  
 Date of Practical Completion: 19th June 2019

Engineering Consultant: KN Group Pty Ltd

DRAWING REVISIONS	
REV.	REVISION DESCRIPTION
1	INITIAL ISSUE
2	DRAFTING AMENDMENT

DESIGN FILE No.	DESIGNED
CONSTRUCT. No.	DATE
SURVEY FILE No.	DRAWN BJB
FIELD BOOK	DATE 04/12/2019
LOG BOOK	CHECKED CGW
LEVEL DATUM	DATE 04/12/2019
DATUM	

**LANDPARTNERS**  
 built environment consultants

LANDPARTNERS PTY LTD  
 BRISBANE HEAD OFFICE  
 Level 6, 100/102 Creek Street  
 MELTON QLD 4064  
 Telephone: (07) 3842 1000  
 www.landpartners.com.au

CITY OF **GOLDCOAST.**

GOLD COAST CITY COUNCIL  
 833 SOUTHPORT NERANG ROAD  
 NERANG QLD 4211  
 PH: 1300 465 326

SCALE 1:500 ORIGINAL SIZE A1

SUBDIVISION REFERENCE	
PN346230/12/DA1	
PAGE NO. 1 OF 1	
LPL PLAN NUMBER	
BR004595-003-309-2	



**LEGEND**

●	(FH) FIRE HYDRANT
⊠	(VS) STOP VALVE
✱	(VA) SCOUR ASSEMBLY
□	(RT) READY TAP
×	(WM) WATER METER
┌	END CAP
└	TEE
>	REDUCER
○	BEND
—	WATER MAIN
- - -	CONDUIT/CROSSING
—	EXISTING WATER



**NOTES**  
 -ALL WATER MAIN RETICULATION PIPES ARE PVC-0 PN16 U.N.O.  
 -ALL FIRE HYDRANTS ARE #100 SPRING U.N.O.  
 -ALL SERVICE CONDUIT PIPES ARE #100 uPVC PN12 U.N.O.

**Works As Constructed**

It is certified that the locations, Levels and dimensions of the infrastructure shown herein are a true representation of the constructed works and that the As-Constructed survey was performed to the prescribed accuracy standards.

Authorised Delegate: *C. Walters*  
 Date: 26/02/2020  
 LandPartners Pty Ltd (ACN 118 146 008) Surveyor No. S4118

**Works As Constructed**

It is certified that works herein have been constructed to Local Government standards, relevant approved specifications and the operational works approval. The As-Constructed Drawings for these works constitutes a true and correct record of the works constructed and complies with the design intent.

Signature: *[Signature]* RPEQ No. *1908*  
 Date of Practical Completion: *29/12/20*  
 Engineering Consultant: *RN Group Pty Ltd*

REV.	REVISION DESCRIPTION
1	INITIAL ISSUE
2	DRAFTING AMENDMENT
3	AMENDED ISSUE

DESIGN FILE No.	DESIGNED
CONSTRUCT. No.	DATE
SURVEY FILE No.	DRAWN BJB
FIELD BOOK	DATE 26/02/2020
LOG BOOK	CHECKED CGW
LEVEL DATUM	DATE 26/02/2020
DATUM	

**LANDPARTNERS**  
 built environment consultants

LANDPARTNERS PTY LTD  
 BRISBANE HEAD OFFICE  
 Level 1, 90 Little Crab Street  
 MELB (VIC) 3000  
 Telephone: 973 3612 900  
 www.landpartners.com.au

**CITY OF GOLD COAST.**  
 GOLD COAST CITY COUNCIL  
 833 SOUTHPORT NERANG ROAD  
 NERANG QLD 4211  
 PH: 1300 465 326

SCALE 1:500 ORIGINAL SIZE A1

SUBDIVISION REFERENCE	
PN346230/12/DA1	
PAGE NO. 1 OF 1	
LPL PLAN NUMBER	
BR004595-003-308-3	

**LEGEND**

	BOTTOM OF WALL
	TOP OF WALL
	LIP OF KERB
	BACK OF KERB
	EDGE OF CONCRETE
	EDGE OF ROCK
	CONTOURS
	CHANGE OF GRADE
	BOTTOM OF BANK
	TOP OF BANK
	CROWN OF ROAD
	FENCE

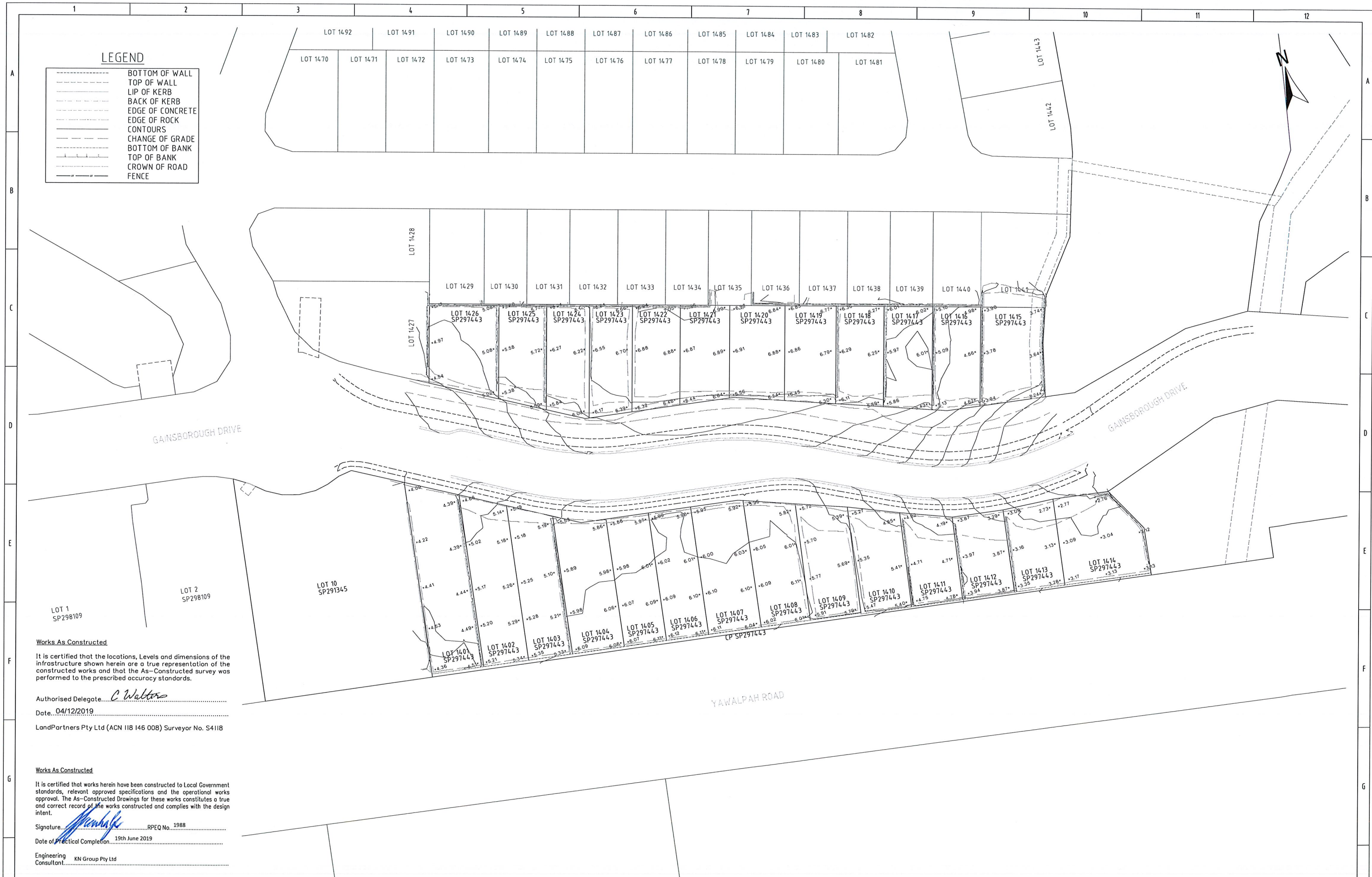

**Works As Constructed**

It is certified that the locations, Levels and dimensions of the infrastructure shown herein are a true representation of the constructed works and that the As-Constructed survey was performed to the prescribed accuracy standards.

Authorised Delegate: *C. Walters*  
 Date: 04/12/2019  
 LandPartners Pty Ltd (ACN 118 146 008) Surveyor No. S4118

**Works As Constructed**

It is certified that works herein have been constructed to Local Government standards, relevant approved specifications and the operational works approval. The As-Constructed Drawings for these works constitutes a true and correct record of the works constructed and complies with the design intent.

Signature: *[Signature]* RPEQ No. 1988  
 Date of Practical Completion: 19th June 2019  
 Engineering Consultant: KN Group Pty Ltd

DRAWING REVISIONS		DESIGN FILE No.	DESIGNED
REV.	REVISION DESCRIPTION	CONSTRUCT. No.	DATE
1	INITIAL ISSUE	SURVEY FILE No.	DRAWN BJB
2	ADD WALL SEGMENT LOT 1414	FIELD BOOK	DATE 04/12/2019
		LOG BOOK	CHECKED CGW
		LEVEL DATUM	DATE 04/12/2019
		DATUM	



LANDPARTNERS PTY LTD  
 BRISBANE HEAD OFFICE  
 Level 1, 181 Little Collins Street  
 MELBOM 3000  
 Telephone: 07 3842 9000  
 www.landpartners.com.au

CITY OF  
**GOLD COAST.**

GOLD COAST CITY COUNCIL  
 833 SOUTHPORT NERANG ROAD  
 NERANG QLD 4211  
 PH: 1300 465 326

SCALE 1:500

ORIGINAL SIZE A1

GAINSBOROUGH GREENS PRECINCT 3.1A  
 AS CONSTRUCTED TOPOGRAPHY

SUBDIVISION REFERENCE	
PN346230/12/DA1	
PAGE NO. 1 OF 1	
LPL PLAN NUMBER	
BR004595-003-310-2	